

# Shim Plates / Height Adjusting Pins

-Square · Round-

-Standard · Male Thread-

CAD Data



Type			Material	Hardness
No Hole Type	Hole Type	Blank Type		
KJTC	KJTCH	KJTCB	1.0038/S235JR	-
KJTCC	-	-	1.1191/C45E	40-45HRC

\*When T=2, only countersinking is applicable.

**No Hole Type**

\* For 1 countersink hole

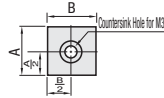

\* For 2 countersink holes

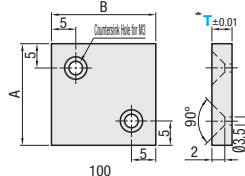

**Hole Type**

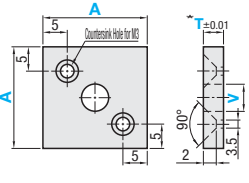

**Blank Type**

(Cut as required.)

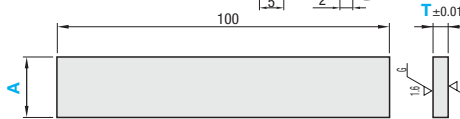

**No Hole Type**

Part Number	Type	No.	Number of Counter-sinks	T Selection	A	B	€ Unit Price		
							T=2	3	5
(No Hardening) KJTC	KJTC	10	1	2	10	10			
		10-15			15				
		10-20			20				
		15			15				
		15-20			20				
(Hardening) KJTCC	KJTCC	18	2	3	18	18			
		20			20				
		20S			20				
		20-25			25				
		20-30			30				
(Hardening) KJTCCY	KJTCCY	20-40	2	5	20	20			
		25			25				
		25			25				
		25			25				
		30			30				

**Hole Type**

Part Number	Type	A	T Selection	V Selection			€ Unit Price		
				T=2	3	5			
(No Hardening) KJTCH	KJTCH	25	2	6	8	10			
		30	3	12	14	16			
		35	5	18	20	22			
				13					

**Blank Type**

Part Number	Type	A	T	€ Unit Price
		19		
		20		

⊕ Sizes without price indications are not available.

**Shim Plates -Round-**



Type	Material	Hardness
KJTCC	1.0038/S235JR	-
KJTCCY	1.1191/C45E	40-45HRC

\*When T=2, only countersinking is applicable.

D=10, 15

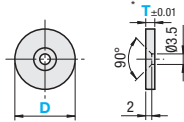

D=20, 25, 30

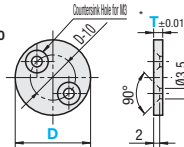

Part Number	Type	D	T Selection	€ Unit Price	
				KJTCC	KJTCCY
KJTCC KJTCCY		10	2 3 5		
		15			
		20			
		25			
		30			

**Height Adjusting Pins -Standard-**



**KJTTP**

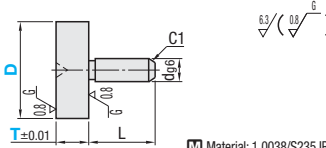

**Height Adjusting Pins -Male Thread-**



**KJTTPM**

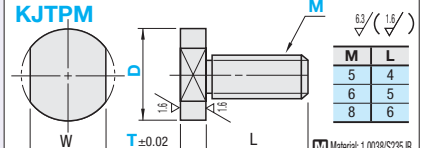

Part Number	Type	D	T Selection	d	L	€ Unit Price
12	5	8				
16	3					
18	5					
20						

Part Number	Type	D	T	M	W	€ Unit Price
12	5	6	10			
16	6	8	14			



Products on this page are for height adjustment.

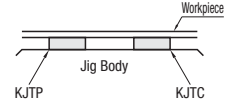

Order Example	Part Number	T	V	M
	KJTCC10-2	- 3		
	KJTCH30	- 5	- V12	
	KJTCCB19	- 3		
	KJTTPM12	- 3		- M6

Days to Ship - KJTCC **6 Days** P88



Volume Discount (⊕ Round down to one Cent.) P87

Quantity	1-9	10-15	16-19	20-49
Rate	€ Unit Price	5%	10%	18%

⊕ For orders larger than indicated quantity, please request a quotation.

Other Types **8 Days**

Express A 2,00 EUR/piece P88

⊕ A Express Charge of 5,40 EUR for 3 or more identical pieces.